

sunExt

LATICCES

ENG

CATALOG





Privacy



Estetic



**perfect
to
custom**

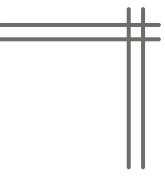

Index

Introduction	01
System Variants	02
Max degrees for slats	03
Slats size	04
Lattice scheme	05
Fixed in frame	06
Slat models	07
Distance between slats	08
Extrusion profiles	09
Slat models	10
Extrusion profiles	11

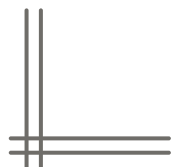



Index

Fixed lateraly	12
Slat models	13
Manual	14
Slat models & Extrusion Profiles & Accesories Manual Lattice 120	15
Accesories Manual Lattice 120	16
Extrusion Profiles & Accesories Manual Lattice 210	17
Accesories Manual Lattice 210	18
Extrusion Profiles & Accesories Manual Lattice 300	19
Accesories Manual Lattice 300	20
Motorized	21
Slat models	22



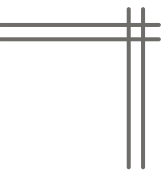

Index

Extrusion Profiles & Accesories Motorized Lattice 120	23
Accesories Motorized Lattice 120	24
Extrusion Profiles & Accesories Motorized Lattice 210	25
Accesories Motorized Lattice 210	26
Extrusion Profiles & Accesories Motorized Lattice 300	27
Accesories Motorized Lattice 300	28
Extrusion Profiles & Accesories Motorized Lattice 420	29
Accesories Motorized Lattice 420	30
Extrusion Profiles & Accesories Motorized Lattice 431	31
Treatmenst and finishes	32





Introduction

EXPALUM Lattices are innovative, very effective, safe and aesthetic construction solution for wall and front of building coverings in homes, premises, offices, industries or hotels.

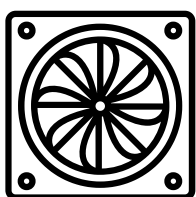

Ventilation allows air circulation while keeping the room protected from the sun, a very notable aspect for the hot summer months.

Privacy, The design of the slats ensures you can maintain privacy while still enjoying natural light and airflow. With certain configurations it is possible to adjust the flow of light and air according to your preferences.

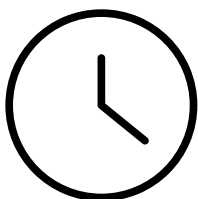

Aesthetics and durability, it adapts to the needs of all users since we have a wide range of slat models and colors.

Energy savings, causes greater thermal comfort inside, reducing heating needs and helping to save energy.



System Variants

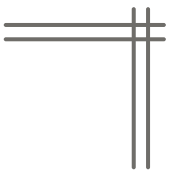

Fixed: "A durable and solid option for those who value longevity and a simple, functional design. Once installed, it provides stable and reliable shading without the need for adjustment, ideal for long-lasting comfort and protection."



Manual: "Flexibility to suit your needs. The movable system allows you to manage shading based on weather conditions and personal preferences. An adaptable solution with the option for manual panel adjustments."

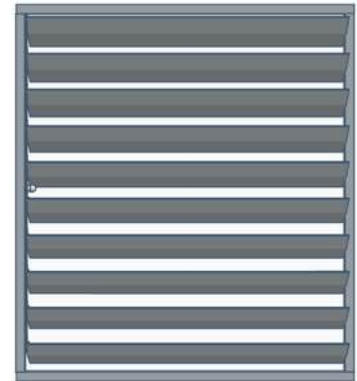

Motorized: "Cutting-edge technology. Control shading with a touch thanks to the motorized system. Perfect for those who appreciate maximum convenience and automation."



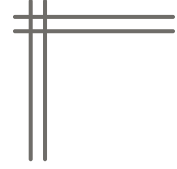

Max degrees for slats

maximum opening angle for the lattices is 150 degrees

0°



45°



90°



150°



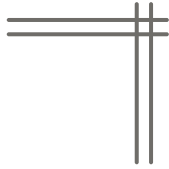

Slats size

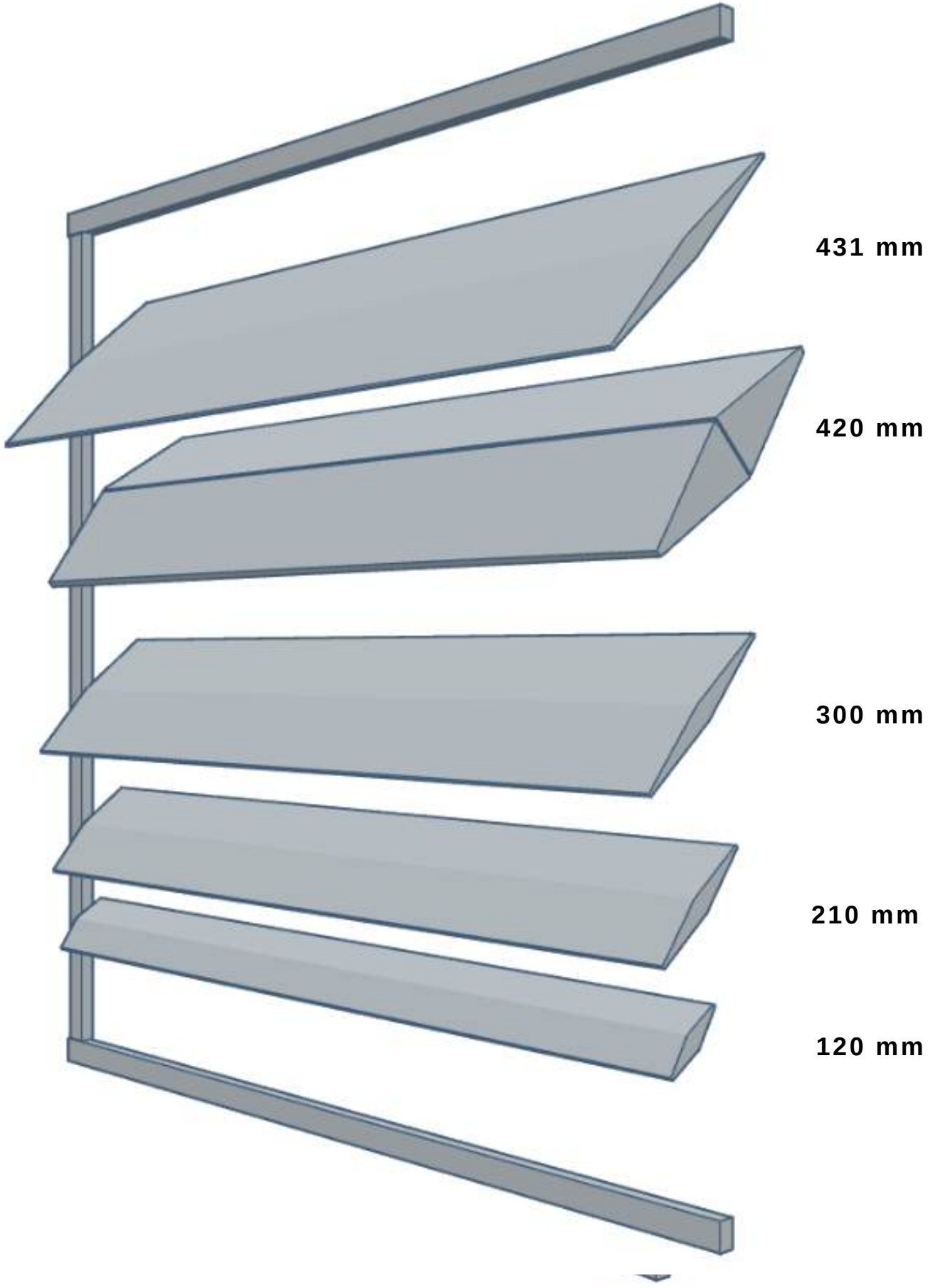

Lattice scheme

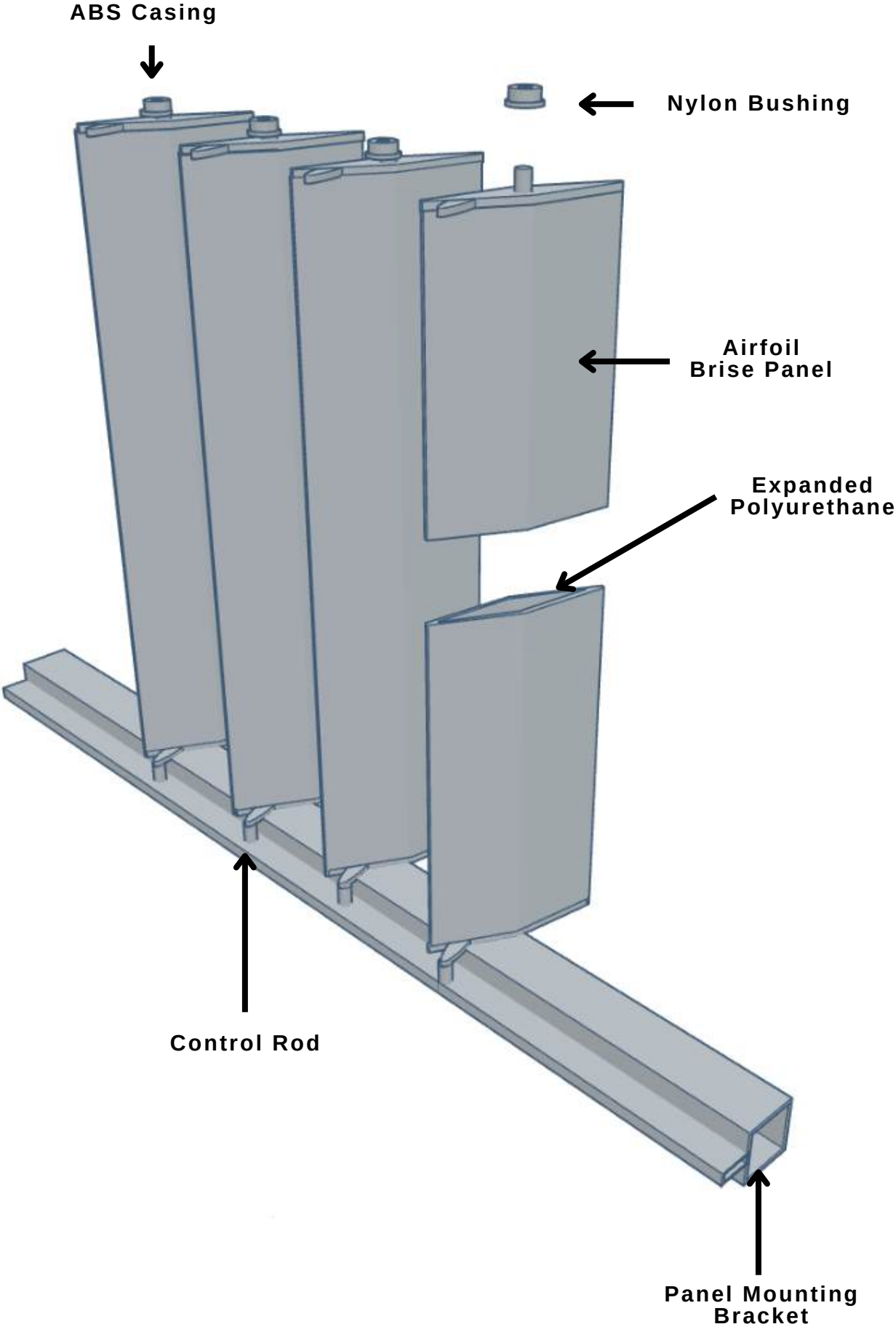

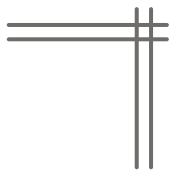

Fixed in frame

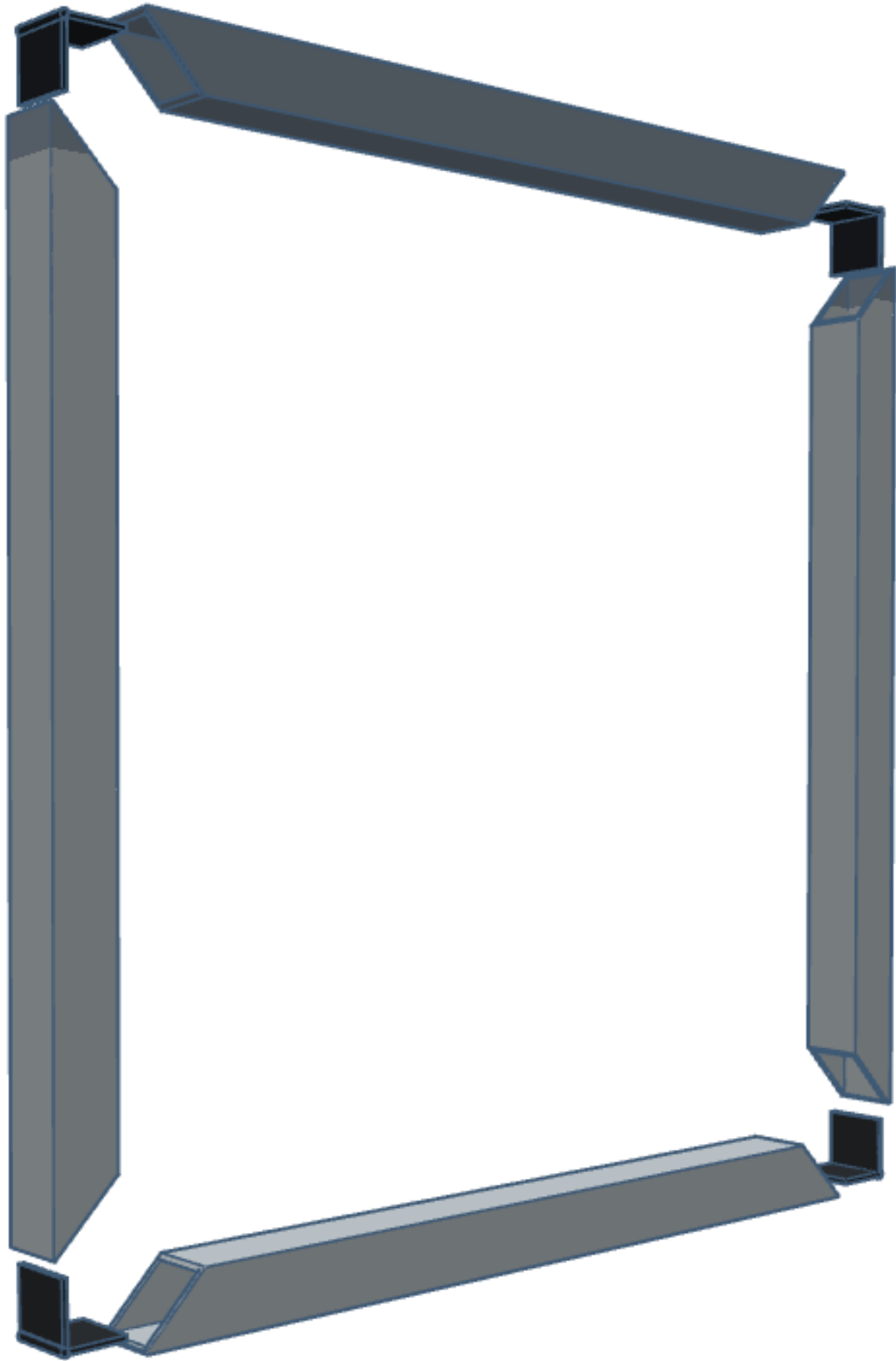

sunExt

Slat models

CFE01

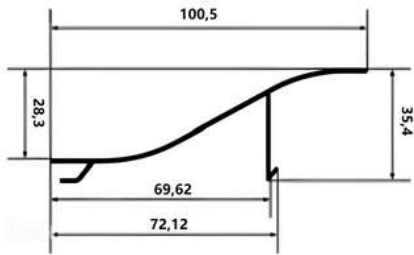

CFE02

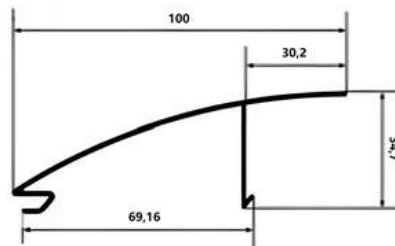

CFE03

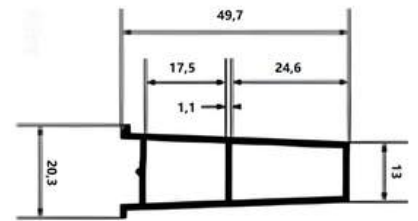

Factor



Factor



FEATURES CARACTÉRISTIQUES CARACTERÍSTICAS

		CFE01	CFE02	CFE03	
Material	Materiel	6063-T5			
Slat size	Pas de lame	100,5	100	13	mm
Nominal thickness	Épaisseur nominale	35,4	34,7	49,7	mm
Slats per meter	Nombre de lames au mètre	10 (Pitch 30 mm)	10 (Pitch 30 mm)	22 (Pitch 25 mm)	u.
Maximun advised width (Three aluminium frame)	Largeur maximale recommandé (trois cadre en aluminium)	3.500	3.500	3.500	mm
Lenght	Longueur de fabrication	6	6	6	m
Slat exterior perimeter	Périmètre extérieur lame	297,09	319,29	197,32	mm

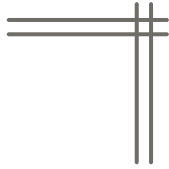

Distance between slats

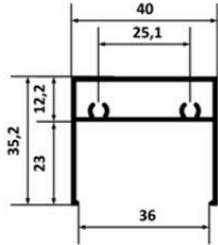

Area (mm ²)	Theoretical weight (kg/ml)	total (m ² /ml)	surface exterior (m ² /ml)	inertia Lx (cm ⁴) Ly (cm ⁴)	Module Wx (cm ³) Wy (cm ³)
172	0.466	0.314	0.206	2.39 4.37	0.95 2.19

ALUMINIUM FRAME CADRE EN ALUMINIUM SOPORTE DE ALUMINIO



MODEL E0022



MODEL E0023

Sections Section Sección

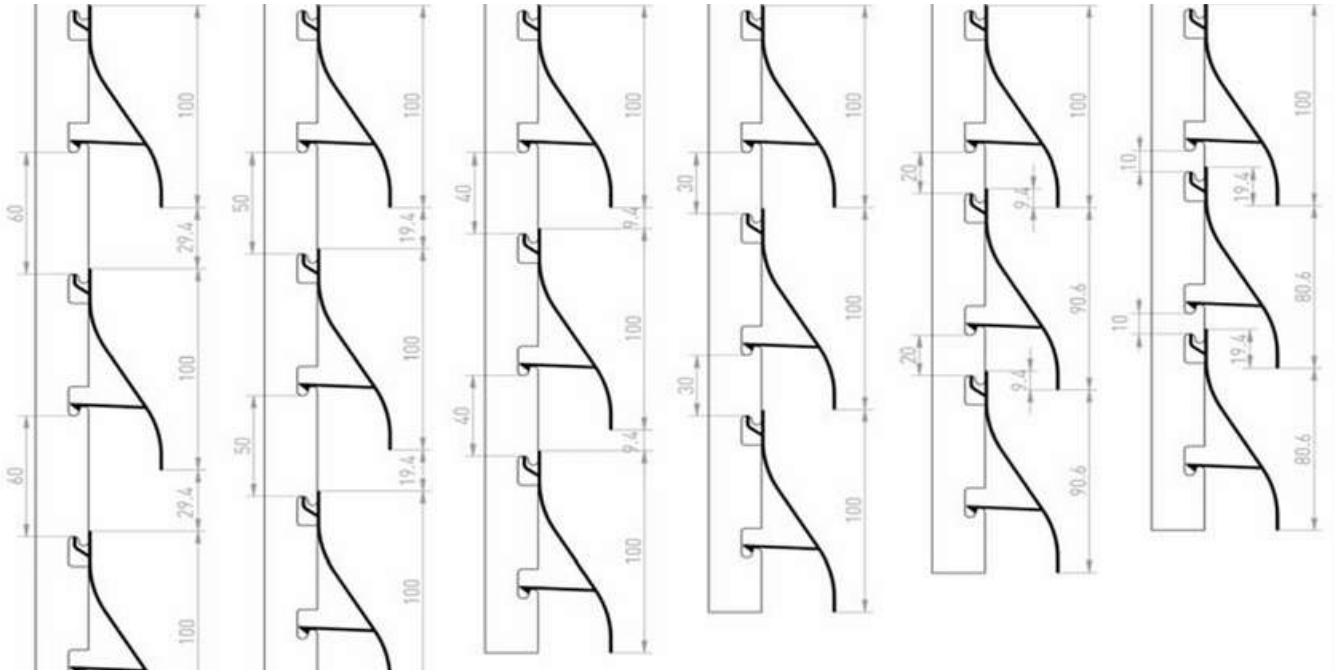
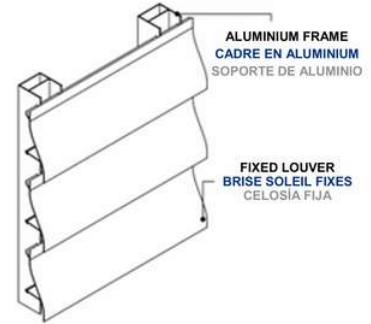

Wheelbase Empattement Distancia entre ejes

Pitch 3 - 60 mm	Pitch 2 - 50 mm	Pitch 1 - 40 mm	Pitch 0 - 30 mm	Pitch 1 - 20 mm	Pitch 2 - 10 mm
29.5 mm	19.5 mm	9.5 mm	0 mm	-9.5 mm	-19.5 mm

Distance between strips Distance entre les lames Distancia entre las lamas

• Maximum distances placement Distances maximales d'emplacement Distancias máximas de colocación

A: 250 mm
B: 1500 mm

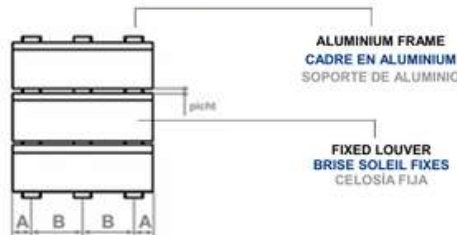

Extrusion profiles

E0114 - 20026 - SQUARE
TUBE 40x40x1.3 MM

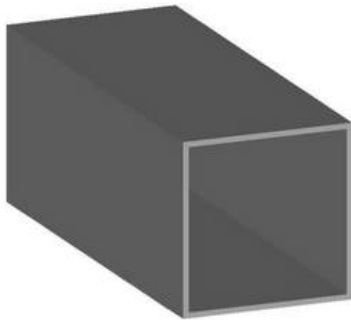

CE011 - FIXED
LATTICE SUPPORT
V6110



CE008 - SUPPORT
TREILLIS 35x40 DÉCOUPE
CF01-02 PASO 0

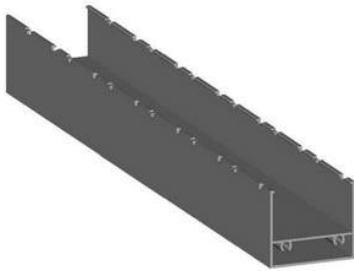

CE009 - SUPPORT
TREILLIS 35x40 DÉCOUPE
35x40 CF03 PASO 45

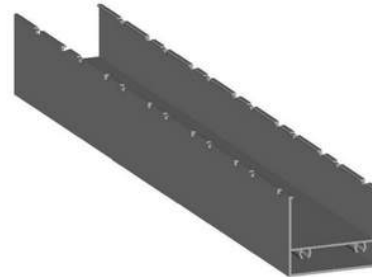

Accesorios

CE022 - CAP KIT FOR
LATTICE CFE02



CE023 - CAP KIT FOR
LATTICE CFE01



AJ0023 - CAP FOR
LATTICE CFE03

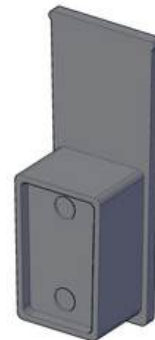

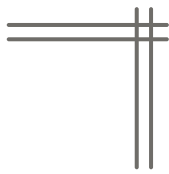

Slat models

**CE006 - 19619 - LATTICE
MODEL SQ02 120 MM (K)**

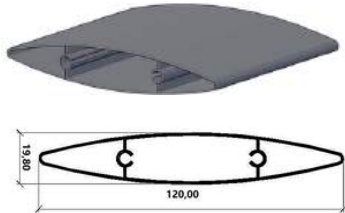

**CE007 - 19620 - LATTICE
MODEL SQ01 210 MM (K)**

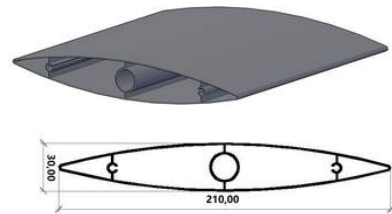

**CE018 - LATTICE MODEL
300 MM (K)**



**CE019 - LATTICE MODEL
420MM REF:10026**

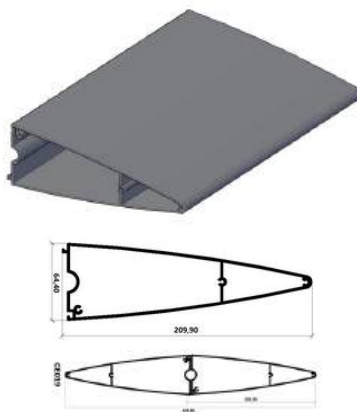

Louver 431 mm

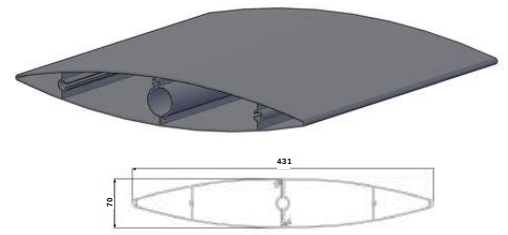

Extrusion profiles

E0114 - 20026 - SQUARE
TUBE 40x40x1.3 MM

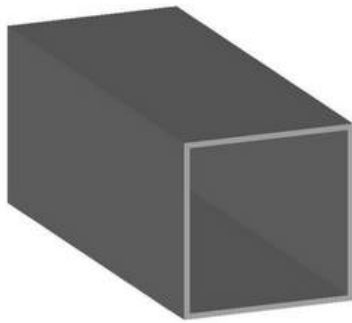

CE011 - FIXED
LATTICE SUPPORT
V6110



Accessories

AJ0004F - ALUMINIUM
LATERAL CAP FOR
LATTICE SQ02 (120)
REF:106343



PA092 - SCREW FOR SLAT
COVER A2 4.2 X 16



AJ0003F - ALUMINIUM
LATERAL CAP FOR
LATTICE SQ01 (210)
REF:106344



AJ0012 - KIT REGULABLE
PLIERS FOR SLAT 120
-210 REF:D6072.88



AJ0011 - KIT REGULABLE
PLIERS FOR LATTICE
SLAT 300 REF:D6072.89



AJ0013 - KIT REGULABLE
PLIERS FOR LATTICE
LARGE SLAT
REF:D6072.90



Fixed lateraly

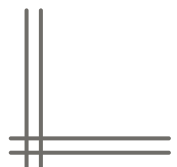
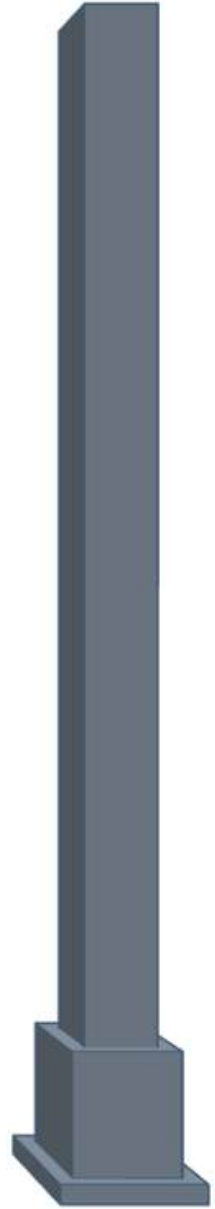
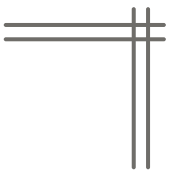

Slat models

CE006 - 19619 - LATTICE
MODEL SQ02 120 MM (K)

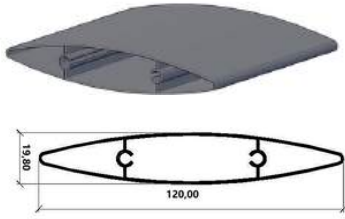

CE007 - 19620 - LATTICE
MODEL SQ01 210 MM (K)

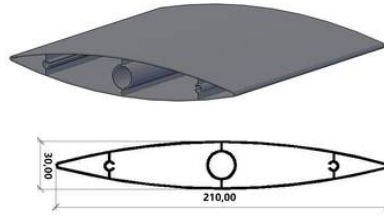

CE018 - LATTICE MODEL
300 MM (K)

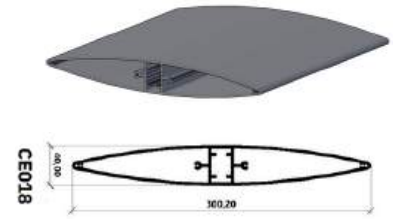

Extrusion profiles & accesories

E0114 - 20026 - SQUARE
TUBE 60x60x1.2 MM

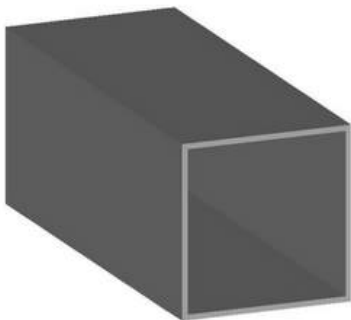

AJ0024



Aj0018S



PA092 - SCREW FOR SLAT
COVER A2 4.2 X 16



Manual

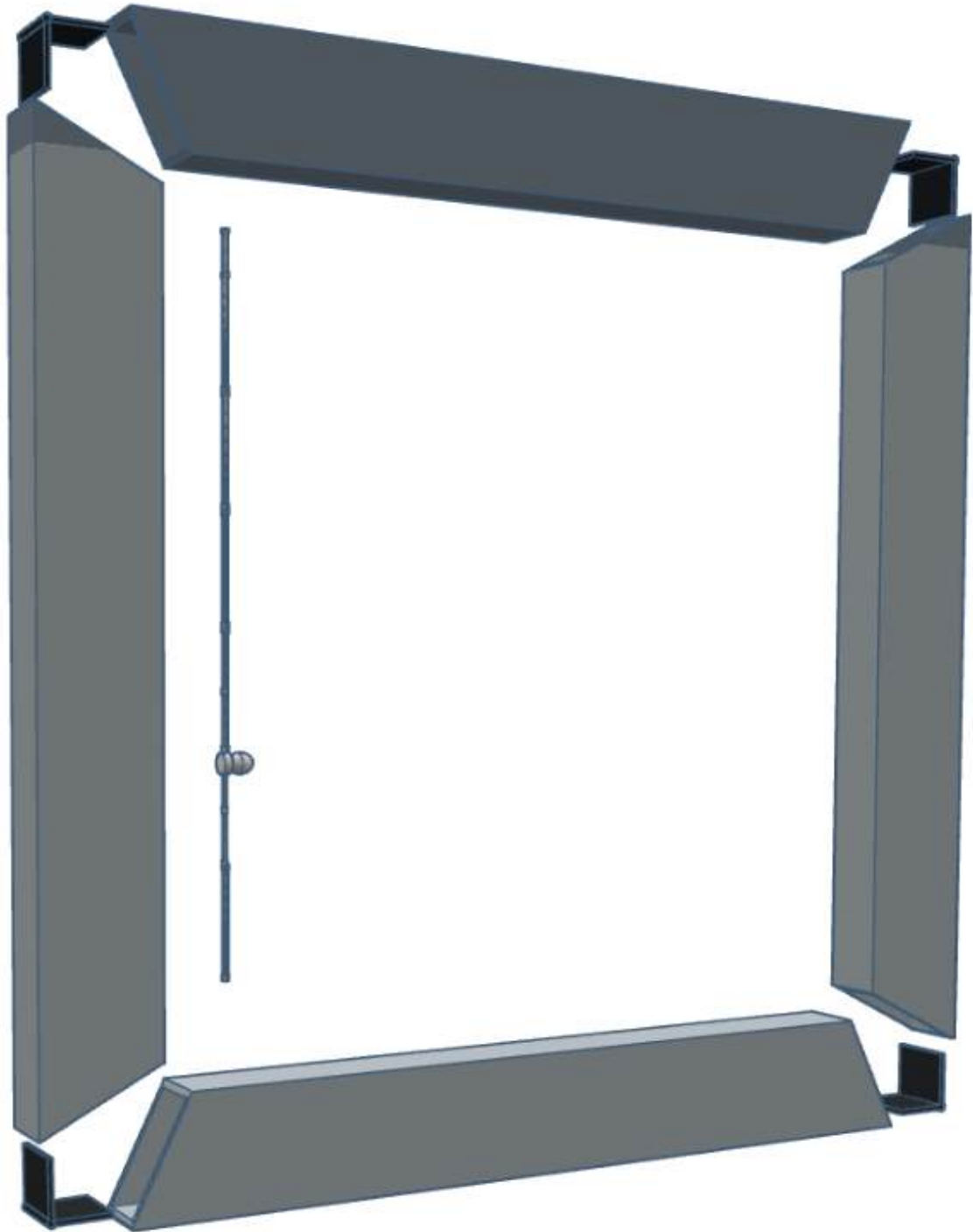
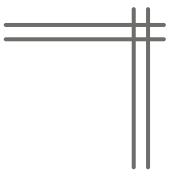

sunExt

Slat models

CE006 - 19619 - LATTICE
MODEL SQ02 120 MM (K)

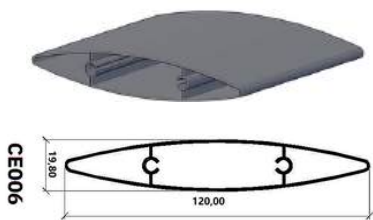

CE007 - 19620 - LATTICE
MODEL SQ01 210 MM (K)

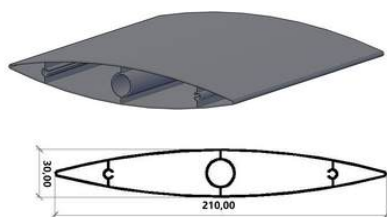

CE018 - LATTICE MODEL
300 MM (K)

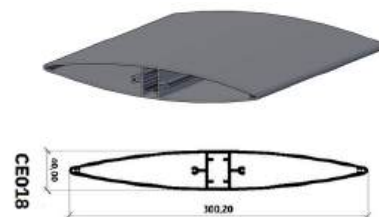

Extrusion Profiles & Accessories Manual Lattice 120

E0111 - 19011 - ANGLE
PROFILE
20 X 20 X 1.5



E0114 - 20026 - SQUARE
TUBE 40x40x1.3 MM

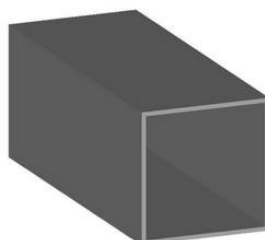

CE020 - FRAME LATTICE
40 X 50 REF:10027

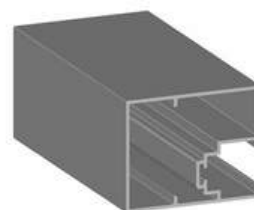

AJ0014 - ORIENTATION
ARC LATTICE
REF:107030



AJ0021 - SLEEVE
FRAME 40 LATTICE
REF:06008



AJ0022 - SLEEVE
ENDCAPS LATTICE 120
REF:06009



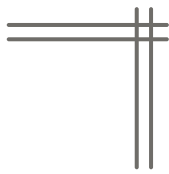

Accessories Manual

Lattice 120

AJ0001 - KIT REGULABLE
PLIERS LATTICE SLAT 300
REF:D6072.89



AJ0004 - ALUMINIUM
LATERAL COVER FOR
LATTICE MODEL SQ02
(120) REF:105694



AJ0020 - ALUMINIUM
LATERAL COVER
PERFORATED FOR
LATTICE MODEL SQ02
(120) REF:112136



AJ0007 - SPRING FOR CAP
FOR MOBILE LATTICE



AJ0019 - KNOB MANUAL
LATTICE



AJ0016 - REMOTE CONTROL
FOR SLATS ORIENTATION
INOX 303 Ø-32 X 12
M-5//M-8 LATTICE



PA092 - SCREW FOR
SLAT COVER A2 4.2 X 16



AJ0010 - BOLT AL. 15 X 12
FOR FASTENER PROFILE



AJ0017 - SCREW A2-070
M5 X 10 MM FOR LATTICE
TRANSMISSION





Extrusion Profiles & Accessories Manual Lattice 210

**E0111 - 19011 - ANGLE
PROFILE
20 X 20 X 1.5**



**AJ0014 - ORIENTATION
ARC LATTICE
REF:107030**



**E0114 - 20026 - SQUARE
TUBE 40x40x1.3 MM**

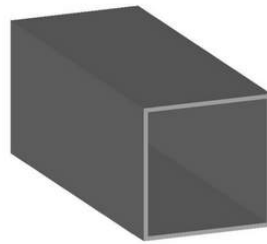

**AJ0021 - SLEEVE
FRAME 40 LATTICE
REF:06008**



**CE020 - FRAME LATTICE
40 X 50 REF:10027**

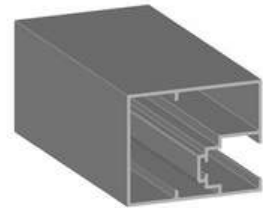

**AJ0022 - SLEEVE
ENDCAPS LATTICE 120
REF:06009**



Accessories Manual

Lattice 210

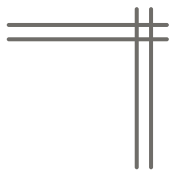

AJ0001 - KIT REGULABLE
PLIERS LATTICE SLAT
REF:D6072.89



AJ0003 - ALUMINIUM
LATERAL COVER ALUMINIO
FOR LATTICE SQ01 (210)
REF:105693



AJ0018 - ALUMINIUM
LATERAL COVER
PERFORATED FOR LATTICE
SQ01 (210) REF:109493



AJ0010 - BOLTL AL. 15 X 12
FOR FASTENER PROFILE



AJ0019 - KNOB MANUAL
LATTICE



AJ0016 - REMOTE CONTROL
FOR SLATS ORIENTATION
INOX 303 Ø-32 X 12
M-5//M-8 LATTICE



PA092 - SCREW FOR SLAT
COVER A2 4.2 X 16



AJ0017 - SCREW A2-070
M5 X 10 MM FOR LATTICE
TRANSMISSION





Extrusion Profiles & Accessories Manual Lattice 300

**E0111 - 19011 - ANGLE
PROFILE**
20 X 20 X 1.5



**AJ0014 - ORIENTATION
ARC LATTICE**
REF:107030



**E0114 - 20026 - SQUARE
TUBE 40x40x1.3 MM**

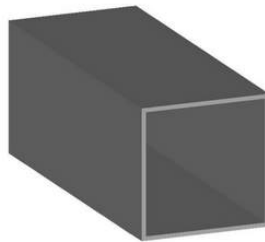

**AJ0021 - SLEEVE
FRAME 40 LATTICE**
REF:06008



CE020 - FRAME LATTICE
40 X 50 REF:10027

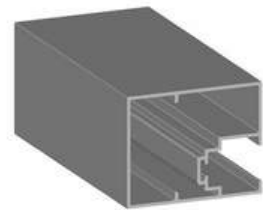

**AJ0022 - SLEEVE
ENDCAPS LATTICE 120**
REF:06009



Accessories Manual

Lattice 300

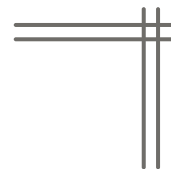

AJ0001 - KIT REGULABLE
PLIERS LATTICE SLAT
REF:D6072.89



AJ0026



AJ0027



AJ0010 - BOLTL AL. 15 X 12
FOR FASTENER PROFILE



AJ0019 - KNOB MANUAL
LATTICE



AJ0016 - REMOTE CONTROL
FOR SLATS ORIENTATION
INOX 303 Ø-32 X 12
M-5//M-8 LATTICE



PA092 - SCREW FOR SLAT
COVER A2 4.2 X 16



AJ0017 - SCREW A2-070
M5 X 10 MM FOR LATTICE
TRANSMISSION



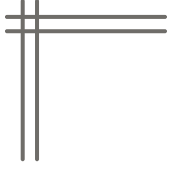

Motorized

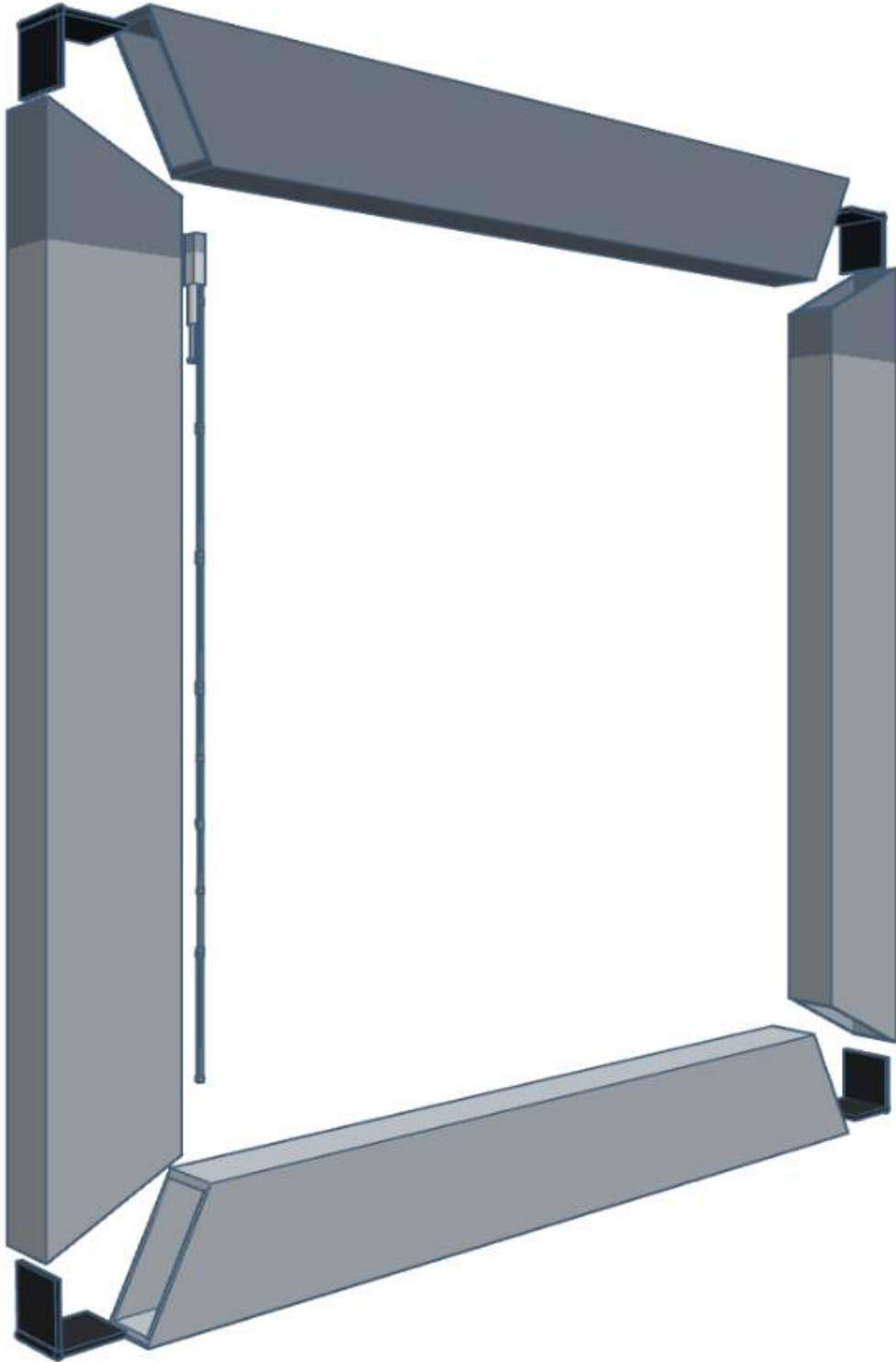

sunExt



Slat models

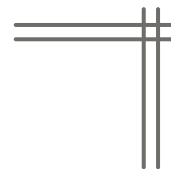

CE006 - 19619 - LATTICE MODEL SQ02 120 MM (K)

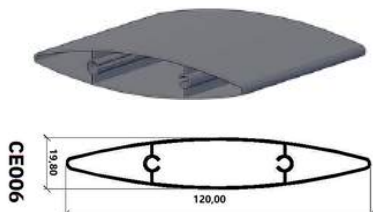

CE007 - 19620 - LATTICE MODEL SQ01 210 MM (K)

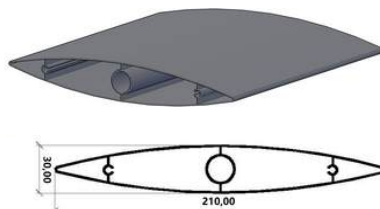

CE018 - LATTICE MODEL 300 MM (K)

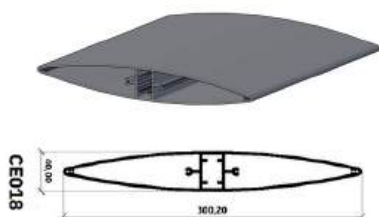

CE019 - LATTICE MODEL 420MM REF:10026

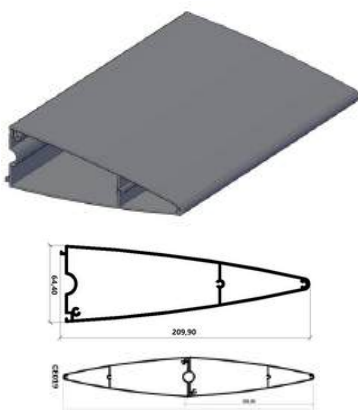

Louver 431 mm

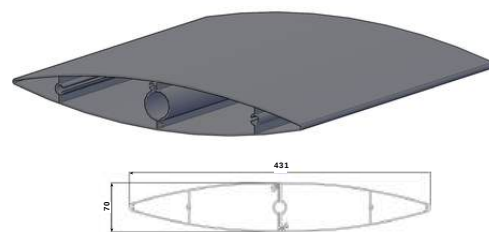

Maximum installation
dismensions for Class 6
(in millimeters)

CE006	2300
CE007	3300
CE018	4500
CE019	Variable, depending on project





Extrusion Profiles & Accessories Motorized Lattice 120

**E0111 - 19011 - ANGLE
PROFILE 20 X 20 X 1.5**



**PF026 - ALUMINIUM TUBE
60 X 40 X 1.3**

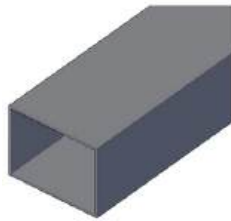

**CE020 - LATTICE FRAME
40 X 50 REF:10027**

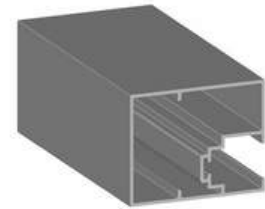

**E0111 - 19011 - ANGLE
PROFILE 20 X 20 X 1.5**



**E0111 - 19011 - ANGLE
PROFILE 20 X 20 X 1.5**



**E0111 - 19011 - ANGLE
PROFILE 20 X 20 X 1.5**



**E0111 - 19011 - ANGLE
PROFILE 20 X 20 X 1.5**



**E0111 - 19011 - ANGLE
PROFILE 20 X 20 X 1.5**



Accessories

Motorized Lattice

120

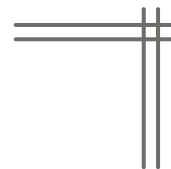

AJ0001 - KIT REGULABLE
PLIERS LATTICE
REF:D6072.89



AJ0021 - SLEEVE FRAME 40
LATTICE REF:06008



AJ0004 - ALUMINIUM
LATERAL COVER FOR
LATTICE MODEL SQ02 (120)
REF:105694



AJ0022 - SLEEVE ENDCAPS
LATTICE 120 REF:06009



AJ0020 - ALUMINIUM
LATERAL COVER
PERFORATED FOR LATTICE
MODEL SQ02 (120)
REF:112136



AJ0009 - LINEAR ACTUATOR
RIGID PISTON ROD 500N
CAREER 200 FOR LATTICE



AJ0007 - SPRING FOR CAP
FOR MOBILE LATTICE



AJ0010 - SCREW A2-070
M5 X 10 MM FOR LATTICE
TRANSMISSION





Extrusion Profiles & Accessories Motorized Lattice 210

**E0111 - 19011 - ANGLE
PROFILE 20 X 20 X 1.5**



**PF026 - ALUMINIUM TUBE
60 X 40 X 1.3**

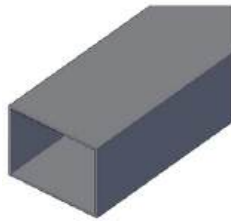

**CE020 - LATTICE FRAME
40 X 50 REF:10027**

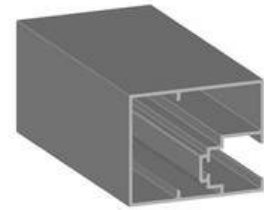

**E0111 - 19011 - ANGLE
PROFILE 20 X 20 X 1.5**



**E0111 - 19011 - ANGLE
PROFILE 20 X 20 X 1.5**



**E0111 - 19011 - ANGLE
PROFILE 20 X 20 X 1.5**



**E0111 - 19011 - ANGLE
PROFILE 20 X 20 X 1.5**



**E0111 - 19011 - ANGLE
PROFILE 20 X 20 X 1.5**



Accessories

Motorized Lattice

210

AJ0001 - KIT REGULABLE
PLIERS LATTICE
REF:D6072.89



AJ0021 - SLEEVE FRAME 40
LATTICE REF:06008



AJ0003 - ALUMINIUM
LATERAL COVER ALUMINIO
FOR LATTICE MODEL SQ01
(210) REF:105693



AJ0009 - LINEAR ACTUATOR
RIGID PISTON ROD 500N
CAREER 200 FOR LATTICE



AJ0018 - ALUMINIUM
LATERAL CAP PERFORATED
FOR LATTICE MODEL SQ01
(210) REF:109493



AJ0010 - SCREW A2-070
M5 X 10 MM FOR LATTICE
TRANSMISSION



AJ0007 - SPRING FOR CAP
FOR MOBILE LATTICE





Extrusion Profiles & Accesories Motorized Lattice 300

**E0111 - 19011 - ANGLE
PROFILE 20 X 20 X 1.5**



**PF026 - ALUMINIUM TUBE
60 X 40 X 1.3**

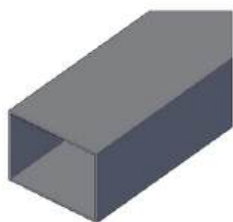

**CE020 - LATTICE FRAME
40 X 50 REF:10027**

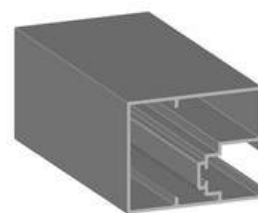

**E0111 - 19011 - ANGLE
PROFILE 20 X 20 X 1.5**



**E0111 - 19011 - ANGLE
PROFILE 20 X 20 X 1.5**



**E0111 - 19011 - ANGLE
PROFILE 20 X 20 X 1.5**



**E0111 - 19011 - ANGLE
PROFILE 20 X 20 X 1.5**



**E0111 - 19011 - ANGLE
PROFILE 20 X 20 X 1.5**



Accesories

Motorized Lattice

300

AJ0001 - KIT REGULABLE
PLIERS LATTICE
REF:D6072.89



AJ0026



AJ0027



AJ0007 - SPRING FOR CAP
FOR MOBILE LATTICE



AJ0021 - SLEEVE FRAME 40
LATTICE REF:06008



AJ0009 - LINEAR ACTUATOR
RIGID PISTON ROD 500N
CAREER 200 FOR LATTICE



AJ0010 - SCREW A2-070
M5 X 10 MM FOR LATTICE
TRANSMISSION





Extrusion Profiles & Accesories Motorized Lattice 420

**E0111 - 19011 - ANGLE
PROFILE 20 X 20 X 1.5**



**PF026 - ALUMINIUM TUBE
60 X 40 X 1.3**

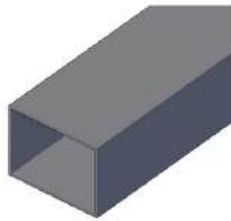

**CE020 - LATTICE FRAME
40 X 50 REF:10027**

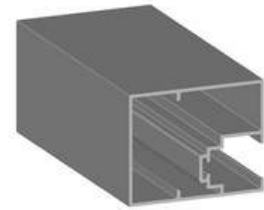

**E0111 - 19011 - ANGLE
PROFILE 20 X 20 X 1.5**



**E0111 - 19011 - ANGLE
PROFILE 20 X 20 X 1.5**



**E0111 - 19011 - ANGLE
PROFILE 20 X 20 X 1.5**



**E0111 - 19011 - ANGLE
PROFILE 20 X 20 X 1.5**



**E0111 - 19011 - ANGLE
PROFILE 20 X 20 X 1.5**



Accessories

Motorized Lattice

420

AJ0001 - KIT REGULABLE
PLIERS LATTICE
REF:D6072.89



AJ0021 - SLEEVE FRAME 40
LATTICE REF:06008



AJ0009 - LINEAR ACTUATOR
RIGID PISTON ROD 500N
CAREER 200 FOR LATTICE



AJ0007 - SPRING FOR CAP
FOR MOBILE LATTICE



AJ0010 - SCREW A2-070
M5 X 10 MM FOR LATTICE
TRANSMISSION



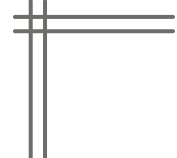

Extrusion Profiles & Accesories Motorized Lattice 431

**E0111 - 19011 - ANGLE
PROFILE 20 X 20 X 1.5**



**PF026 - ALUMINIUM TUBE
60 X 40 X 1.3**

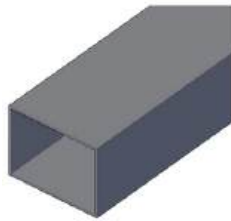

**CE020 - LATTICE FRAME
40 X 50 REF:10027**

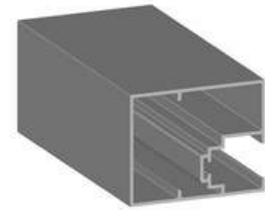

**E0111 - 19011 - ANGLE
PROFILE 20 X 20 X 1.5**



**E0111 - 19011 - ANGLE
PROFILE 20 X 20 X 1.5**



**E0111 - 19011 - ANGLE
PROFILE 20 X 20 X 1.5**



**E0111 - 19011 - ANGLE
PROFILE 20 X 20 X 1.5**



**E0111 - 19011 - ANGLE
PROFILE 20 X 20 X 1.5**



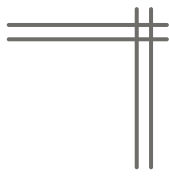

Treatments and finishes

Anodized

After extrusion, the aluminium itself forms a thin film of aluminium oxide that gives it minimal anti-oxidation and anti-corrosion properties. This process improves through anodizing, an electrolytic chemical process that allows artificially obtaining oxide films of much greater thickness and better protection characteristics than natural layers.

Sublimation

Sublimation is a process of transferring an image to the pre-lacquered surface of aluminium, decorating it with a predetermined design.

Lacquer

Lacquering, applied to aluminium profiles, consists of pre-treatment of the surface to be decorated for the subsequent application of powder paint on the surface of the aluminium, which offers high light fastness and resistance to corrosion.

Colors

There is an infinite variety of colors and textures that will allow the user to have total control over each chromatic matrix of the product.

